

NOTES:  
 1. DUE TO OUR CONTINUOUS IMPROVEMENT PROGRAM, ALL MODELS AND SPECIFICATIONS ARE SUBJECT TO CHANGE WITHOUT NOTICE.

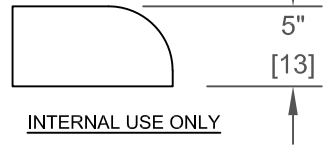
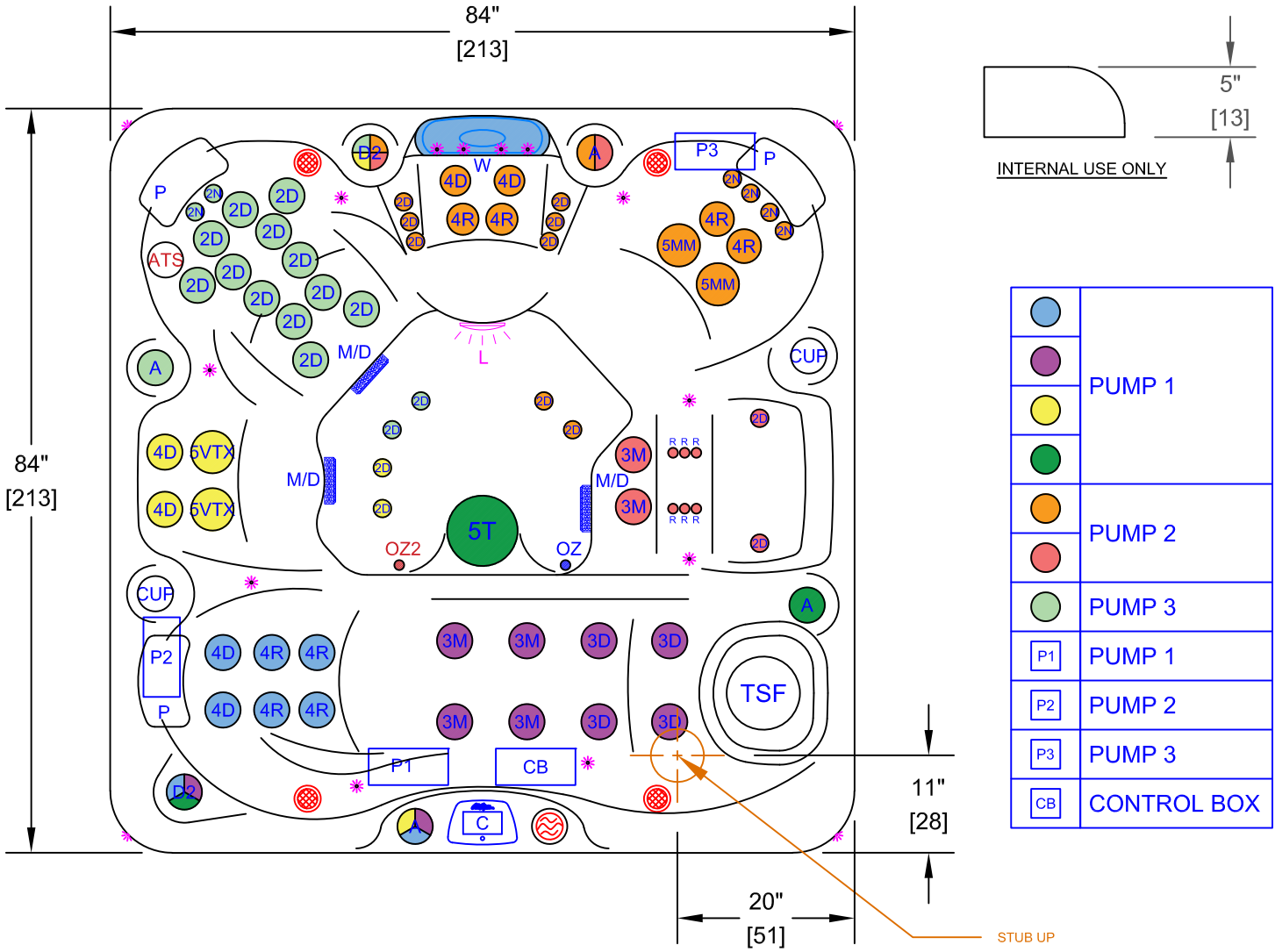

|  |             |
|--|-------------|
|  | PUMP 1      |
|  | PUMP 2      |
|  | PUMP 3      |
|  | PUMP 1      |
|  | PUMP 2      |
|  | PUMP 3      |
|  | CONTROL BOX |

### EC-767LX - LEGEND

| SYMB. | DESCRIPTION  | PART NUMBER      | QTY. |
|-------|--|------------------|------|
| R     | RAIN JET   | PLU23028-392-000 | 6    |
| 2N    | 200 VELOCITY NECK 100%                                     | PLU29920-612-400 | 6    |
| 2D    | 200 VELOCITY DIRECTIONAL                                   | PLU29920-012-400 | 26   |
| 3D    | 300 VELOCITY DIRECTIONAL                                   | PLU29930-112-400 | 4    |
| 3M    | 300 VELOCITY MASSAGE                                       | PLU29930-142-400 | 6    |
| 4D    | 400 VELOCITY DIRECTIONAL                                   | PLU29940-112-400 | 6    |
| 4R    | 400 VELOCITY ROTO  | PLU29940-122-400 | 8    |
| 5VTX  | 500 VELOCITY VTX   | PLU29950-011-400 | 2    |
| 5MM   | 500 VELOCITY MASSAGE - 14                                  | PLU29950-071-400 | 2    |
| 5T    | DOME JET WITH VALVE (1JET)                                 | PLU29950-501-400 | 1    |
| D2    | VELOCITY 2" WATER DIVERTER VALVE                           | PLU25058-202-800 | 2    |
| A     | VELOCITY AIR CONTROL VALVE                                 | PLU25059-202-400 | 4    |
| W     | LED WATERFALL  |                  | 1    |
| TSF   | 50 SQ. FT. TELEWEIR FILTER                                 |                  | 1    |
| M/D   | MAIN DRAIN   |                  | 2    |
| P     | Y-PILLOWS  |                  | 4    |
| C     | CAL SPAS TOUCH 2   |                  | 1    |
| OZ    | PURE SILK OZONATOR WITH MAZZIE INJECTOR AND MIXING CHAMBER |                  | 1    |
|       | BEAM-LITE 4X CABINET CORNER LED LIGHTING                   |                  | 1    |
|       | MULTI COLORED LED LIGHT                                    |                  | 1    |
|       | PERIMETER LED LIGHTING                                     |                  | 1    |

### OPTIONS

| SYMB. | DESCRIPTION  | OPTION NUMBER |
|-------|--|---------------|
| ATS   | EXCLUSIVE ADJUSTABLE THERAPY SYSTEM PLUS (ATS PLUS)                            | OPT22-109     |
|       | TWIN PURE SILK SYSTEM DIAL OZONATORS WITH MAZZIE INJECTORS AND MIXING CHAMBERS | OPT22-102DX-1 |
|       | 24/7 FILTRATION SYSTEM   | OPT22-112C    |
|       | FREEDOM SOUND SYSTEM BLUETOOTH, POWERED SUBWOOFER AND 4X SPEAKERS              | OPT22-FS43    |
| -     | THERMO-GUARD FULL FOAM   | OPT22-900     |
|       | CAL SPAS SALT SYSTEM   | OPT22-113S    |

|  |                    |  |                     |
|--|--------------------|--|---------------------|
| PROPRIETARY AND CONFIDENTIAL<br>THE INFORMATION CONTAINED IN THIS DRAWING IS THE SOLE PROPERTY OF CAL SPAS. ANY REPRODUCTION IN PART OR AS A WHOLE WITHOUT THE WRITTEN PERMISSION OF CAL SPAS IS PROHIBITED. |                    | <br>CAL SPAS INC.<br>1462 EAST NINTH STREET, POIMONA, CA 91766 |                     |
| SPECIFICATIONS   |                    | TITLE  | JET LAYOUT - 113S   |
| DIMENSION (in)   | 84"x84"x40-1/2"    | LINE   | ESCAPE X-SERIES     |
| DIMENSION (cm)   | 213x213x100        | MODEL  | 2022 SPA LINE COSTA |
| DRY WEIGHT   | 800 LBS [363 Kg]   | NUM  | EC-767LX            |
| FILLED WEIGHT  | 4340 LBS [1969 Kg] | DWG NO.  | CS000440            |
|  |                    | REV  | B                   |
| WATER CAP.   | 425 GAL [1609 L]   | SCALE  | NTS                 |
|  |                    |  | SHEET 1 OF 1        |