

NOTES:  
 1. DUE TO OUR CONTINUOUS IMPROVEMENT PROGRAM, ALL MODELS AND SPECIFICATIONS ARE SUBJECT TO CHANGE WITHOUT NOTICE.

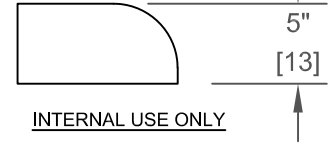
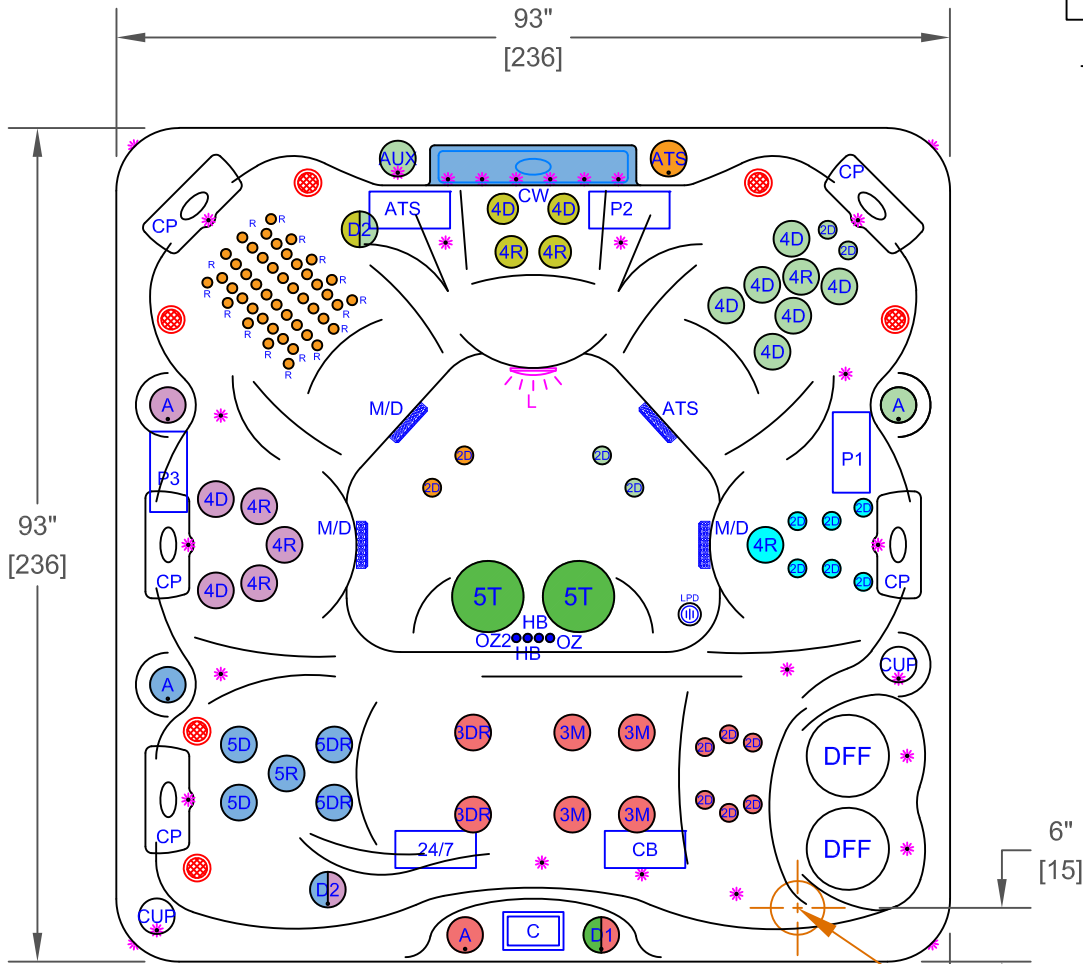

|  |             |
|--|-------------|
|  | PUMP 1      |
|  | PUMP 2      |
|  | PUMP 3      |
|  | ATS         |
|  | PUMP 1      |
|  | PUMP 2      |
|  | PUMP 3      |
|  | PUMP ATS    |
|  | PUMP 24/7   |
|  | CONTROL BOX |

### PL-894L - LEGEND

| SYMB. | DESCRIPTION  | PART NUMBER      | QTY. |
|-------|--|------------------|------|
| R     | RAIN JET   | PLU23028-392-000 | 46   |
| 2D    | 200 VELOCITY DIRECTIONAL   | PLU29920-012-400 | 18   |
| 3M    | 300 VELOCITY MESSAGE   | PLU29930-142-400 | 4    |
| 3DR   | 300 VELOCITY DOUBLE ROTO   | PLU29930-191-400 | 2    |
| 4D    | 400 VELOCITY DIRECTIONAL   | PLU29940-112-400 | 10   |
| 4R    | 400 VELOCITY ROTO  | PLU29940-122-400 | 7    |
| 5D    | 500 VELOCITY DIRECTIONAL   | PLU29950-012-400 | 2    |
| 5R    | 500 VELOCITY ROTO  | PLU29950-081-400 | 1    |
| 5DR   | 500 VELOCITY DOUBLE ROTO   | PLU29950-032-400 | 2    |
| 5T    | 500 VELOCITY DIRECTIONAL   | PLU29950-501-400 | 2    |
| ATS+  | ADJUSTABLE THERAPY SYSTEM +  |                  | 1    |
| D1    | VELOCITY 1" WATER DIVERTER VALVE (UNDERWATER)                                  |                  | 1    |
| D2    | VELOCITY 2" WATER DIVERTER VALVE   | PLU25058-202-800 | 2    |
| A     | VELOCITY AIR CONTROL VALVE   | PLU25059-202-400 | 4    |
| CW    | 20" CASCADE LED WATERFALL  |                  | 1    |
| DF    | 150 SQ. FT. DYNA FLOW FILTER (2X 75 SQ. FT.)                                   |                  | 2    |
| M/D   | MAIN DRAIN   |                  | 2    |
| CP    | CASCADE PILLOWS WITH SILVER LOGO   |                  | 4    |
| C     | CAL SPAS TOUCH 4 WITH AUX PANEL  |                  | 1    |
| OZ    | PURE SILK OZONATOR WITH MAZZIE INJECTOR AND MIXING CHAMBER                     |                  | 1    |
| 24/7  | 24/7 FILTRATION SYSTEM   |                  | 1    |
| OZ2   | TWIN PURE SILK SYSTEM DIAL OZONATORS WITH MAZZIE INJECTORS AND MIXING CHAMBERS |                  | 1    |
| CUP   | LED CUP HOLDER   |                  | 2    |
| LPD   | LOW PROFILE DRAIN  |                  | 1    |
|       | BEAM-LITE 4X CABINET CORNER LED LIGHTING                                       |                  | 1    |
| L     | MULTI COLORED LED LIGHT  |                  | 1    |
|       | PERIMETER LED LIGHTING   |                  | 1    |

### OPTIONS

| SYMB. | DESCRIPTION   | OPTION NUMBER |
|-------|---|---------------|
|       | FREEDOM SOUND SYSTEM BLUETOOTH, POWERED SUBWOOFER AND 4X SPEAKERS | OPT22-FS43    |
| -     | THERMO-GUARD FULL FOAM  | OPT22-900     |
|       | CAL SPAS SALT SYSTEM  | OPT22-113S    |

|  |                    |   |                           |
|--|--------------------|---|---------------------------|
| PROPRIETARY AND CONFIDENTIAL<br>THE INFORMATION CONTAINED IN THIS DRAWING IS THE SOLE PROPERTY OF CAL SPAS. ANY REPRODUCTION IN PART OR AS A WHOLE WITHOUT THE WRITTEN PERMISSION OF CAL SPAS IS PROHIBITED. |                    | <br>CAL SPAS INC.<br>1462 EAST NINTH STREET, POMONA, CA 91766 |                           |
| SPECIFICATIONS   |                    | TITLE   | JET LAYOUT - STD          |
| DIMENSION (in)   | 93"x93"x40-1/2"    | LINE  | PLATINUM                  |
| DIMENSION (cm)   | 236x236x100        | MODEL   | 2022 SPA LINE<br>LA JOLLA |
| DRY WEIGHT   | 900LBS [408 Kg]    | NUM   | PL-894L                   |
| FILLED WEIGHT  | 4650 LBS [2109 Kg] | DWG NO.   | CS000801                  |
| WATER CAP.   | 450 GAL [1703 L]   | REV   | B                         |
| SCALE  |                    | NTS   | SHEET 1 OF 1              |