

NOTES:  
 1. DUE TO OUR CONTINUOUS IMPROVEMENT PROGRAM, ALL MODELS AND SPECIFICATIONS ARE SUBJECT TO CHANGE WITHOUT NOTICE.

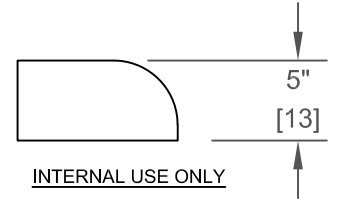
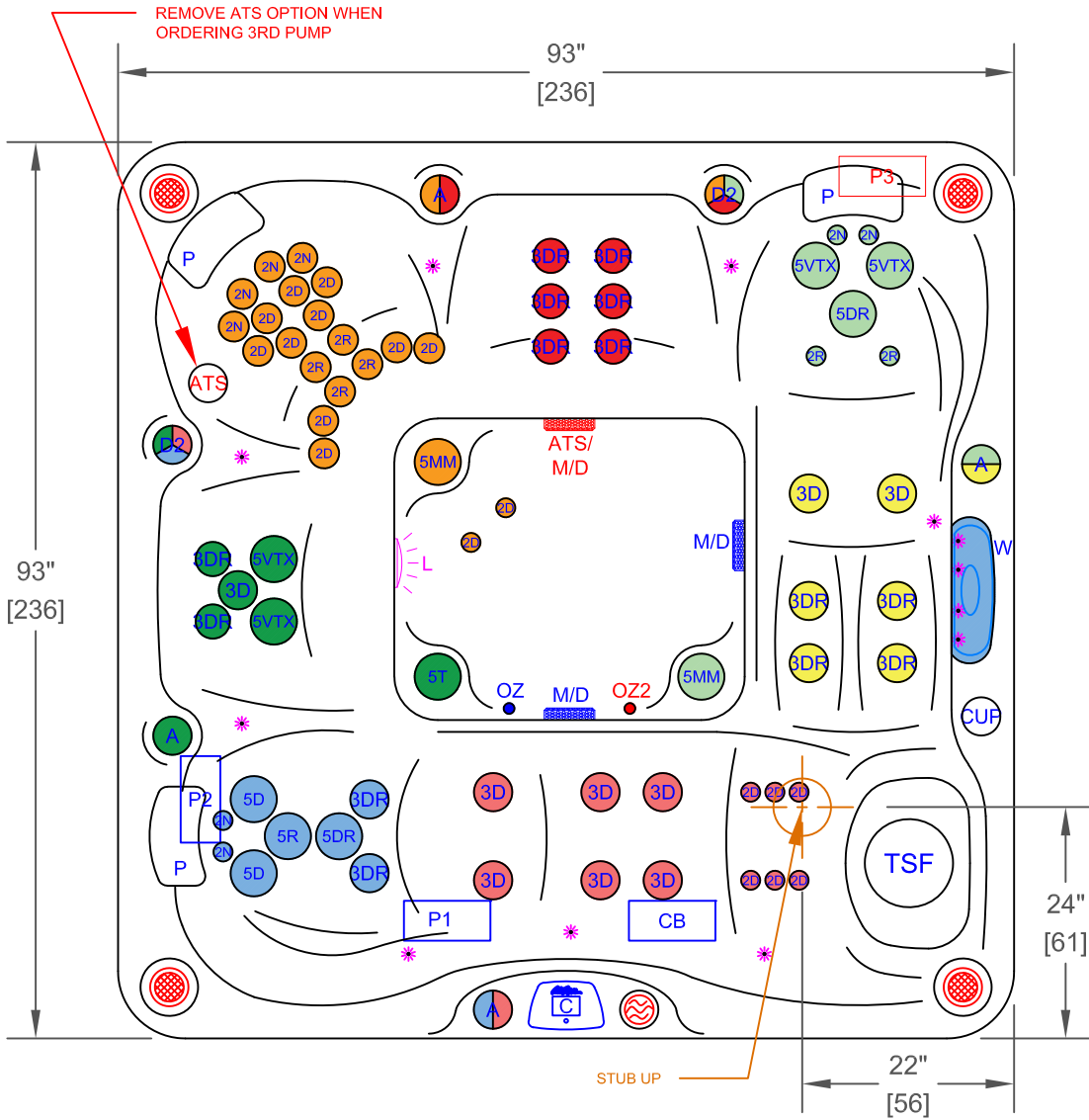

|  |             |
|--|-------------|
|  |             |
|  | PUMP 1      |
|  |             |
|  |             |
|  | PUMP 2      |
|  |             |
|  |             |
|  | PUMP 1      |
|  | PUMP 2      |
|  | CONTROL BOX |

| EC-867DL - LEGEND |  |                  |      |
|-------------------|--|------------------|------|
| SYMB.             | DESCRIPTION  | PART NUMBER      | QTY. |
| 2N                | 200 VELOCITY NECK 100%                                     | PLU29920-612-400 | 8    |
| 2D                | 200 VELOCITY DIRECTIONAL                                   | PLU29920-012-400 | 18   |
| 2R                | 200 VELOCITY ROTO  | PLU29920-022-400 | 6    |
| 3D                | 300 VELOCITY DIRECTIONAL                                   | PLU29930-112-400 | 9    |
| 3DR               | 300 VELOCITY DOUBLE ROTO                                   | PLU29930-191-400 | 14   |
| 5D                | 500 VELOCITY DIRECTIONAL                                   | PLU29950-012-400 | 2    |
| 5R                | 500 VELOCITY ROTO  | PLU29950-081-400 | 1    |
| 5DR               | 500 VELOCITY DOUBLE ROTO                                   | PLU29950-032-400 | 2    |
| 5VTX              | 500 VELOCITY VTX   | PLU29950-011-400 | 4    |
| 5MM               | 500 VELOCITY MESSAGE - 14                                  | PLU29950-071-400 | 2    |
| 5T                | DOME JET WITH VALVE (1JET)                                 | PLU29950-501-400 | 1    |
| D2                | VELOCITY 2" WATER DIVERTER VALVE                           | PLU25058-202-800 | 2    |
| A                 | VELOCITY AIR CONTROL VALVE                                 | PLU25059-202-400 | 4    |
| W                 | LED WATERFALL  |                  | 1    |
| TSF               | 50 SQ. FT. TELEWEIR FILTER                                 |                  | 1    |
| M/D               | MAIN DRAIN   |                  | 2    |
| P                 | Y-PILLOWS  |                  | 3    |
| C                 | CAL SPAS TOUCH 1   |                  | 1    |
| OZ                | PURE SILK OZONATOR WITH MAZZIE INJECTOR AND MIXING CHAMBER |                  | 1    |
| L                 | LED COLORED LIGHT  |                  | 1    |
| *                 | PERIMETER LED LIGHTING                                     |                  | 1    |

| OPTIONS |  |                                     |
|---------|--|-------------------------------------|
| SYMB.   | DESCRIPTION  | OPTION NUMBER                       |
| ATS     | EXCLUSIVE ADJUSTABLE THERAPY SYSTEM PLUS (ATS PLUS)                            | OPT22-109 N/A WITH 3RD PUMP OR 24/7 |
| P3      | ADDITIONAL 3RD PUMP 1 X 6 BHP (OPTION WILL UPGRADE CONTROL BOX TO BP501X)      | OPT22-138B-3P N/A WITH ATS OR 24/7  |
| OZ2     | TWIN PURE SILK SYSTEM DIAL OZONATORS WITH MAZZIE INJECTORS AND MIXING CHAMBERS | OPT22-102DX-1                       |
| 24/7    | 24/7 FILTRATION SYSTEM   | OPT22-112C                          |
|         | FREEDOM SOUND SYSTEM BLUETOOTH, POWERED SUBWOOFER AND 4X SPEAKERS              | OPT22-FS43                          |
| -       | THERMO-GUARD FULL FOAM   | OPT22-900                           |
|         | CAL SPAS SALT SYSTEM   | OPT22-113S                          |

|  |                    |  |                         |
|--|--------------------|--|-------------------------|
| PROPRIETARY AND CONFIDENTIAL<br>THE INFORMATION CONTAINED IN THIS DRAWING IS THE SOLE PROPERTY OF CAL SPAS. ANY REPRODUCTION IN PART OR AS A WHOLE WITHOUT THE WRITTEN PERMISSION OF CAL SPAS IS PROHIBITED. |                    | <br>CAL SPAS INC.<br>1462 EAST NINTH STREET, POIMONA, CA 91766 |                         |
| SPECIFICATIONS   |                    | TITLE  | JET LAYOUT - 113S       |
| DIMENSION (in)   | 93"x93"x40-1/2"    | LINE   | ESCAPE                  |
| DIMENSION (cm)   | 236x236x100        | MODEL  | 2022 SPA LINE<br>AVALON |
| DRY WEIGHT   | 900LBS [408 Kg]    | NUM  | EC-867DL                |
| FILLED WEIGHT  | 4650 LBS [2109 Kg] | DWG NO.  | CS002041                |
|  |                    | REV  | A                       |
| WATER CAP.   | 450 GAL [1703 L]   | SCALE  | NTS                     |
|  |                    |  | SHEET 1 OF 1            |